

Contour 500E  
Contour 580E  
Contour 650E

CTE25  
CTE27  
CTE30

## **GB Operation Instructions**

Turbotrimmer

---

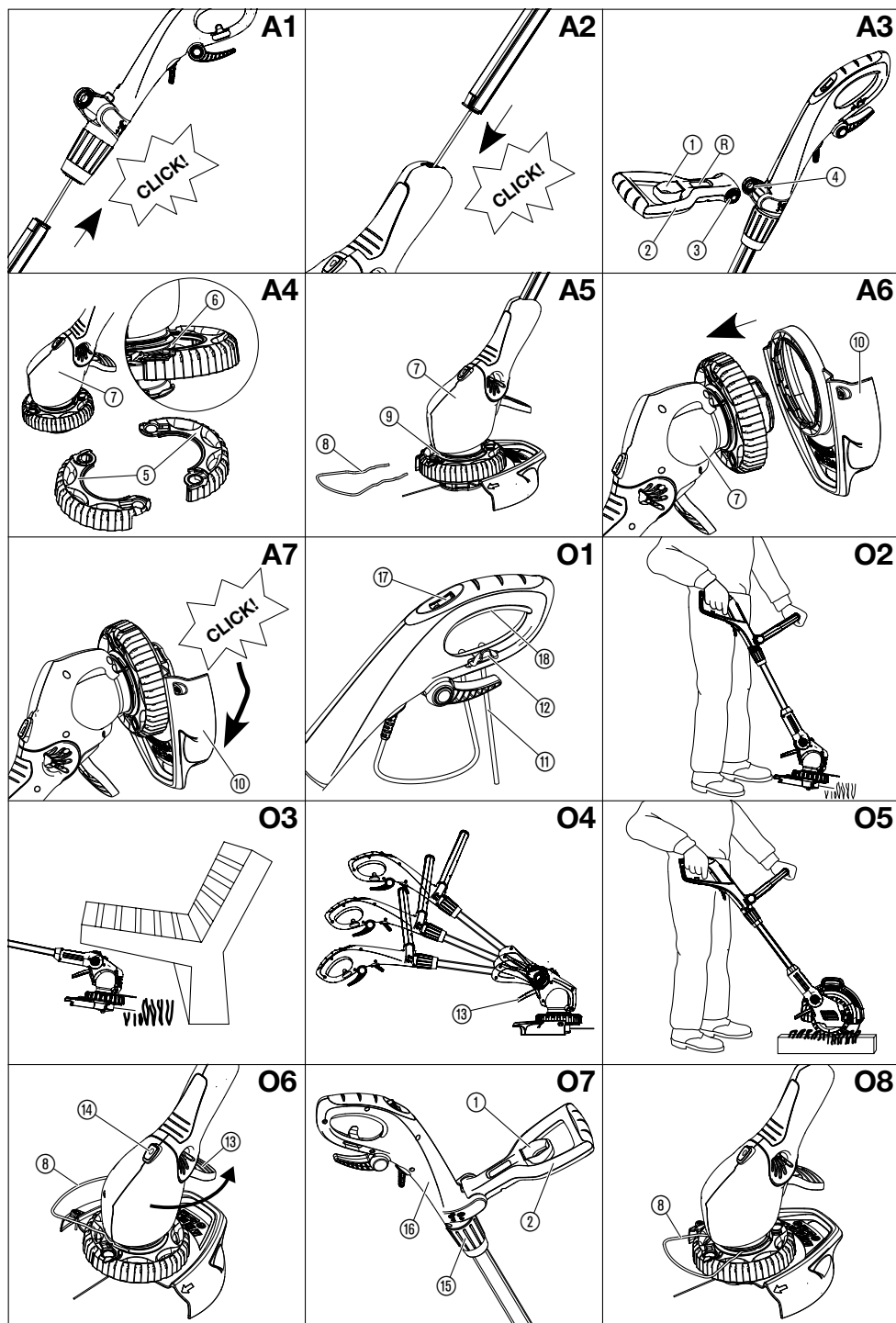

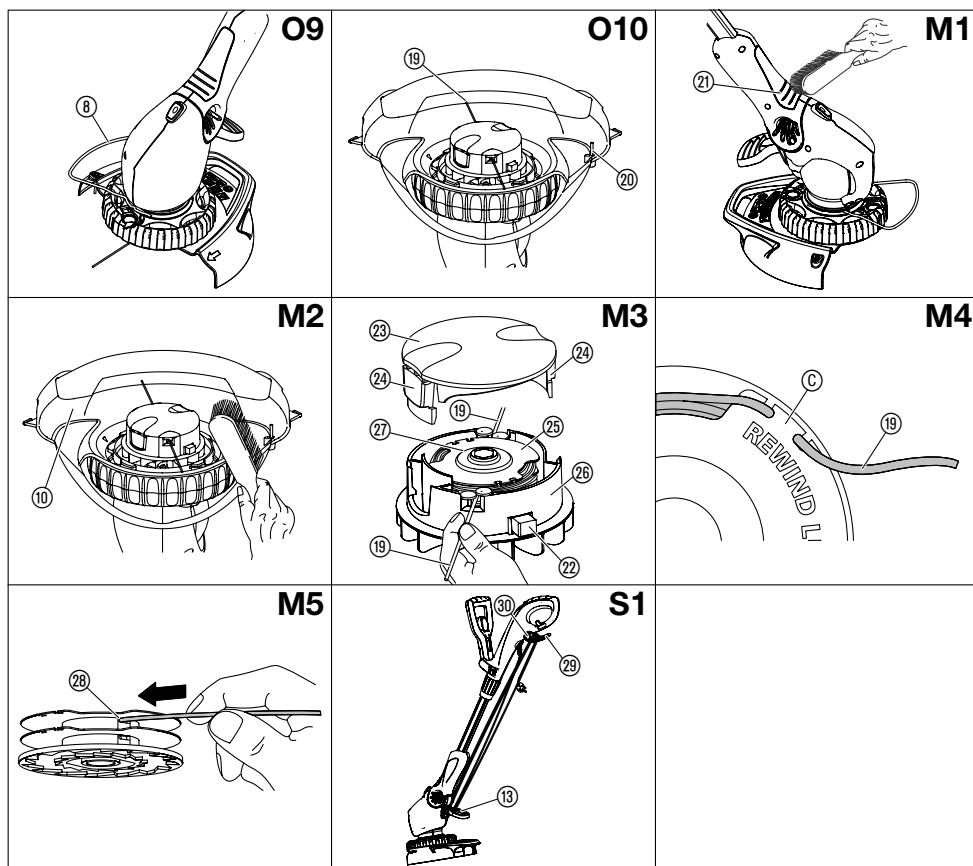

## FLYMO Turbotrimmer Contour 500E / 580E / 650E

### Table of Contents:

1. SAFETY .....	4
2. ASSEMBLY .....	5
3. OPERATION .....	5
4. MAINTENANCE .....	6
5. STORAGE .....	7
6. TROUBLESHOOTING .....	7
7. TECHNICAL DATA .....	8
8. ACCESSORIES .....	9
9. Service/Warranty .....	9

The initial language of these instructions is English.  
Other language versions are translations of the initial instructions.



This product may be used under supervision, or if instruction regarding the safe use of the

product has been provided and the resulting dangers have been understood, by children aged 8 and above, as well as by persons with physical, sensory or mental disabilities or a lack of experience and knowledge. Children must not be allowed to play with the product. Cleaning and user maintenance must not be performed by children without supervision. The use of this product by young people under the age of 16 is not recommended. Never operate the product when you are tired, ill or under the influence of alcohol, drugs or medicine.

**Intended use:**

The FLYMO Turbotrimmer is used to trim and to cut grass and lawns in private house and hobby gardens.

Do not use the product in public facilities, parks, sports grounds, adjacent to roads or in agriculture or forestry.

**DANGER! Risk of injury! Do not use the product to cut hedges, to shred or to make compost.**

## 1. SAFETY

### **Symbols on the product:**



**Read operator's manual.**



**Keep other persons away.**

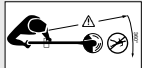

**Danger!**

**Risk of injury to other persons!**

**→ Keep other persons out of the work area.**



**Wear safety glasses and ear protection.**



**Do not let the product become wet with rain or other moisture. Do not leave the product outdoors while it is raining.**



**Disconnect the mains cable if the cable becomes damaged or entangled.**

### **General safety warnings**

#### **Important**

**Read carefully before use.**

**Keep for further reference.**

#### **Safe operating practices**

##### **Training**

- Read the instructions carefully. Be familiar with the controls and the correct use of the machine.
- Never allow children or people unfamiliar with these instructions to use the machine. Local regulations can restrict the age of operator.
- Keep in mind that the operator or user is responsible for accidents or hazards occurring to other people or their property.

##### **Preparation**

- Before use check the supply and extension cord for signs of damage or aging. If the cord becomes damaged during use, disconnect the cord from the supply immediately.  
**DO NOT TOUCH THE CORD BEFORE DISCONNECTING THE SUPPLY.**  
Do not use the machine if the cord is damaged or worn.
- Before use, always visually inspect the machine for damaged, missing or misplaced guards or shields.
- Never operate the machine while people, especially children, or pets are nearby.

### **Operation**

- Keep supply and extension cords away from cutting means.
- Wear eye protection and stout shoes at all times while operating the machine.
- Avoid using the machine in bad weather conditions especially when there is a risk of lightning.
- Use the machine only in daylight or good artificial light.
- Never operate the machine with damaged guards or shields or without guards or shields in place.
- Switch on the motor only when the hands and feet are away from the cutting means.
- Always disconnect the machine from the power supply (i.e. remove the plug from the mains, remove the disabling device or removable battery).
  - whenever the machine is left unattended;
  - before clearing a blockage;
  - before checking, cleaning or working on the machine;
  - after striking a foreign object;
  - whenever the machine starts vibrating abnormally.
- Take care against injury to feet and hands from the cutting means.
- Always ensure that the ventilation openings are kept clear of debris.

### **Maintenance and storage**

- Disconnect the machine from the power supply (i.e. remove the plug from the mains, remove the disabling device or removable battery) before carrying out maintenance or cleaning work.
- Use only the manufacturer's recommended replacement parts and accessories.
- Inspect and maintain the machine regularly. Have the machine repaired only by an authorized repairer.
- When not in use, store the machine out of reach of children.

### **Recommendation**

The machine should be supplied via a residual current device (RCD) with a tripping current of not more than 30 mA.

#### **Cables**

Use only permitted extension cables as per HD 516.

→ Ask your electrical specialist.

If the unit got hot during operation, let it cool down before storage.

### **Additional Safety warnings**

Warning! Keep toddlers away when you assemble the unit. *Small parts can be easily swallowed. There is also*

a risk that the polybag can suffocate toddlers.

**Warning!** When wearing hearing protection, and due to the noise produced by the unit, the operator may not notice persons approaching.

If the unit starts unintentionally when the mains plug is connected, disconnect the mains at once. Contact FLYMO Service to check the unit.

**Warning!** This unit makes an electromagnetic field while it operates. This field may under some conditions interfere with active or passive medical implants. To decrease the risk of conditions that can possibly injure or kill, we recommend persons with medical implants to speak with their physician and the medical implant manufacturer before operating.

If your trimmer is damaged in any way contact your local approved service centre.

→ Never use a damaged trimmer.

Inspect the area to be cut before each use. Remove all objects such as stones, broken glass, nails, wire, string etc, which can be thrown or become entangled in the trimmer head.



**Warning:** The cutting line continues to rotate after the machine has been switched off.



**Warning:** Beware of finger entrapment while putting the upper and the lower shaft together [Fig. A1].

Unplug the device immediately in case it doesn't stop anymore.

Do not lean over the trimmer guard – objects may be thrown by the cutting line.

Don't use the trimmer for pond, river, stream, or creek care. Water in the product could cause a malfunction, or an electrical shock.

Do not operate the trimmer in explosive atmospheres, such as in the presence of flammable liquids, gases or dust. Trimmers create sparks which may ignite the dust or fumes.

If the unit starts unintentionally when the mains plug is connected, disconnect the mains at once. Contact FLYMO to check the unit.

## 2. ASSEMBLY



### CAUTION!

**The trimmer may only be operated provided that the protective cover ⑩ is assembled.**

### To assemble the trimmer:

1. Insert the tube into the switch handle [Fig. A1].  
*Make sure that the internal cable is not twisted.*
2. Push until it clicks into position.  
*Make sure that the tube is fully located by attempting to remove it.*
3. Insert the tube into the trimmer head [Fig. A2].  
*Make sure that the internal cable is not twisted.*
4. Push until it clicks into position.  
*Make sure that the tube is fully located by attempting to remove it.*
5. Pull the lock ① belonging to the additional handle ②, push in both of the snap-fits ③ belonging to the

additional handle ② and, with the grooves ⑤ pointing forwards, snap them into the holder ④ [Fig. A3].

6. Place both halves of the impeller ⑥ around the lower groove ⑥ of the trimmer head ⑦ and close until they audibly engage [Fig. A4].
7. From the front, push the plant guard ⑧ into the upper groove ⑨ of the trimmer head ⑦. In doing so, ensure that the installed bow can rotate freely (i.e. insert the bow with the kink pointing upwards) [Fig. A5].
8. Place the protective cover ⑩ on top of the trimmer head ⑦ [Fig. A6].
9. Turn the protective cover ⑩ until it can be pushed over the trimmer head entirely.
10. Rotate the protective cover ⑩ anti-clockwise until it audibly engages [Fig. A7].

## 3. OPERATION



### DANGER! Risk of physical injury!

**Cut injury when the product starts accidentally.**

→ Before you connect, adjust or transport the product, disconnect the mains cable and transport the product by the bottom handle.

### To connect the trimmer [Fig. O1]:



### DANGER! Risk of electric shock!

**To avoid damage to the mains cable ⑧ it must be inserted into the cable lock ⑫.**

→ Before you operate the product insert the mains cable ⑪ into the cable lock ⑫.

1. Loop the mains cable ⑪, insert the loop into the cable lock ⑫ and pull tight.
2. Connect the mains cable ⑪ into a 230 V mains socket.

### To set the work positions:

**CAUTION! Avoid contact between the ground and the trimmer head in working position 1 + 2.**

#### Work position 1 [Fig. O2]:

For standard trimming.

#### Work position 2 [Fig. O3/O4]:

Trimming beneath obstacles.

1. Push the foot pedal ⑬ and lower the shaft downwards into the desired working position.
2. Release the foot pedal ⑬ and allow the shaft to engage.

**Work position 3 [Fig. O5/O6]:**

Vertical trimming of overhanging lawn edges.

**The upright must be in the uppermost position in working position 3.**

1. Turn the plant guard ⑧ through 90° into the **Parking position** until it engages.
2. Push the foot pedal ⑬ and move the upright into the uppermost position.
3. Push the button ⑭ and rotate the trimmer head from 0° to 90° until it engages.
4. With the impeller, move the trimmer along the lawn edge.

**To set the trimmer to the body height [Fig. O7]:****To set the shaft length:**

- Loosen the clamping sleeve ⑮, extend the handle ⑯ to the desired shaft length and re-tighten the clamping sleeve ⑮.

The clamping sleeve ⑮ must be fastened firmly enough to prevent the shaft from being moved.

**To set the additional handle:**

- Pull the lock ① belonging to the additional handle ②, set the additional handle ② to the desired incline and release the lock ①.

If the trimmer is correctly set to the body height, the posture is upright and the trimmer head in **work position 1** is tilted forwards slightly.

- Hold the trimmer by the handle ⑫ and additional handle ② in such a manner that the trimmer head is tilted forwards slightly.

**To adjust the plant guard [Fig. O8/O9]:**

**Working position [Fig. O8]/Parking position [Fig. O9]**

- Turn plant guard ⑧ through 90° into the required position until it locks into place.

**To start the trimmer [Fig. O1]:****DANGER! Risk of physical injury!**

**Risk of injury if the product does not stop when you release the start button.**

- **Do not bypass the safety devices or switches. For example do not attach the start lever ⑩ to the handle.**

**To start:**

The product is fitted with a two-handed safety device (start lever ⑩ with safety interlock ⑦) to prevent the product from being turned on by accident.

1. Push the safety interlock ⑦ with one hand and pull the start lever ⑩ with the other hand.
2. Release the safety interlock ⑦.

**To stop:**

- Release the start lever ⑩.

**To extend the cutting filament (double auto feed system) [Fig. O10]:**

A clean cut is achieved only with the maximum filament ⑨ length.

The cutting filament ⑨ is **lengthened automatically** when the filament cassette comes to a **standstill** after **switch off**.

As the filament can only be lengthened in small increments, it can be necessary in some cases to repeat the switch-off/switch-on action several times (up to 6 times). Important is that the filament cassette comes to a complete standstill each time.

The cutting filament has been sufficiently lengthened when, after switch-on, it audibly strikes the filament limiter ⑳.

The filament cassette has to be replaced when the cutting filament has been used up:

**FLYMO Filament Cassette and Cutting Filament:**

- |               |        |                     |
|---------------|--------|---------------------|
| • 500E        | FLY021 | Part.no.: 513937190 |
| • 580E / 650E | FLY061 | Part.no.: 510245990 |

## 4. MAINTENANCE

**DANGER! Risk of physical injury!**

**Cut injury when the product starts accidentally.**

- **Before you maintain the product, make sure that the mains cable is disconnected.**

**To clean the trimmer [Fig. M1/M2]:****DANGER! Electric shock!**

**Risk of injury and risk of damage to the product.**

- **Do not clean the product with water or with a water jet (in particular high-pressure water jet).**

**The airflow slots must always be clean.**

1. Clean the airflow slots ⑮ with a soft brush (do not use a screwdriver).

2. Clean all movable parts after each operation. Especially remove any grass and dirt from the cover ③.

**To pull the cutting filament manually out of the filament cassette [Fig M3]:**

A cutting filament that is too short or no longer extends automatically when the trimmer is turned on can be pulled out manually.

1. Push and release manual feed button ㉔, while you gently pull on one of the filaments ⑨ until the filament reaches the filament limiter.
2. When the required amount of filament is fed out, gently pull on the second filament (There is no need to push the manual feed button ㉔ again).
3. If the filament extends past the filament limiter, too much filament has been fed out. Remove the cassette cover ㉓ and click filament cassette anti-clockwise until the filament is at the desired length.

Always return the product to its normal operating position before you start again.

### To replace the filament cassette or the cutting filament:



**DANGER! Risk of physical injury!**

**Risk of injury from metal cutting parts!**

→ Do not use metal cutting parts or replacement parts and accessories not approved by FLYMO.

Only use original FLYMO Filament Cassettes.

You can order Replacement Filament Cassettes from your FLYMO dealer or directly from the FLYMO Customer Service. You can buy either a Replacement Filament Cassette or the Cutting Filament only.

#### FLYMO Filament Cassette and Cutting Filament:

- 500E                      FLY021                      Part.no.: 513937190
- 580E / 650E           FLY061                      Part.no.: 510245990

1. Push and hold the two latches (24).
2. Remove the cassette cover (23).
3. Remove the old filament cassette (25).
4. Remove all dirt in the cassette holder (26).
5. Release one filament (19) from the cleat (27) of the new filament cassette (25).
6. Secure the filament (19) into one slot (27).

7. Pull approximately 10 cm of the filament (19) out of the filament cassette (25) through the slot (27) in the cassette holder (26).
8. Repeat for the second filament.
9. Put the filament cassette (25) into the cassette holder (26). *Make sure, the filament is not caught and the latches (24) are locked.*
10. **Check that the filament cassette (25) is correctly locked. (Try to remove the filament cassette (25) without to push the latches (24).**

### To replace the cutting filament [Fig. M3/M5]:

1. Remove the filament cassette (25).
2. Remove all dirt in the cassette holder (26).
3. Take approximately 5 meters of one filament (19) and insert it into one of the filament lock holes (28) in the filament cassette (25).
4. Wind the filament (19) onto the filament cassette (25) in the direction of the arrows on the top of the filament cassette (25). (Wind the first filament on the upper section of the filament cassette (25).) *Make sure, the filament (19) is neatly wound on the filament cassette (25).*
5. Repeat for the second filament.
6. Replace the filament cassette (25).

## 5. STORAGE

### To put into storage [Fig. S1]:

The product must be stowed away from children.

1. Disconnect the mains cable.
2. Clean the product.
3. Wind the cable around the cable hook (29) and the foot pedal (18). (To unwind the cable push the button (30) and turn the cable hook (29) down.)
4. Stow the product in a dry area where it has protection from frost.

#### Recommendation:

The product can be hung up by the handle. The cutting head is not put under too much strain if the product is stowed hanging up.

### Disposal:

(in accordance with RL2012/19/EC)

The product must not be added to usual household waste. Refer to local environmental laws for discarding.

→ Important: Make sure that the product is discarded through your municipal recycling collection centre.



## 6. TROUBLESHOOTING



**DANGER! Risk of physical injury!**

**Cut injury when the product starts accidentally.**

→ Before you troubleshoot the product, make sure that the mains cable is disconnected.

Problem	Possible Causes	Remedy
Filament is to short or trimmer vibrates	Filament not fed out and visible.	→ Pull the filament until it reaches the filament limiter
	Filament not removed from the cleat.	→ Remove the filament from the cleat.

Problem	Possible Causes	Remedy
<b>Filament is to short or trimmer vibrates</b>	Filament is jammed on the filament cassette.	→ Rewind the filament to remove crossed loops. Check that the filament is neatly wound. If it does not help change the filament cassette.
	Filament is broken inside the filament cassette.	→ Replace the cutting filament.
<b>Continuous clattering noise</b>	Motor has not reached full speed before use.	→ Allow the motor to reach full speed before use.
	Too much filament has been fed out.	→ Rewind the filament.
	Filament limiter is missing.	→ Contact your local approved Service Center or Husqvarna UK Ltd. Customer Service.
<b>Filament snaps continuously</b>	You do not use the correct working position.	→ Use the correct working position.
	Filament is jammed on the filament cassette.	→ Rewind the filament to remove crossed loops. Check that the filament is neatly wound. If it does not help change the filament cassette.
<b>Poor performance</b>	The cassette holder is dirty.	→ Clean the cassette holder.



For any other malfunctions please contact the Husqvarna UK Ltd. Customer Service. Repairs must only be done by Husqvarna UK Ltd. service departments or specialist dealers approved by FLYMO.

## 7. TECHNICAL DATA

	Unit	Value (CTE25)	Value (CTE27)	Value (CTE30)
<b>Motor power consumption</b>	W	500	580	650
<b>Mains voltage</b>	V	230	230	230
<b>Mains frequency</b>	Hz	50	50	50
<b>Cutting filament thickness</b>	mm	1.5	2.0	2.0
<b>Cutting width</b>	cm	25	27	30
<b>Cutting filament supply</b>	m	5	5	5
<b>Cutting filament feed</b>		Manual filament feed system	Manual filament feed system	Manual filament feed system
<b>Speed of cutting filament</b>	rpm	11,500	9,800	8,500
<b>Weight</b>	kg	3.1	3.2	3.4
<b>Sound pressure level <math>L_{pa}^{1)}</math> Uncertainty <math>k_{pa}</math></b>	dB(A)	80.4 2.5	79.3 2.5	80.1 2.5
<b>Sound power level <math>L_{WA}^{2)}</math> measured / guaranteed Uncertainty <math>k_{WA}</math></b>	dB(A)	92 / 96 X.X	91 / 96 X.X	90 / 96 X.X
<b>Hand/arm vibration <math>a_{vhw}^{1)}</math> Uncertainty <math>k_a</math></b>	m/s <sup>2</sup>	2.0 1.5	3.6 1.5	3.0 1.5

Measuring process complying with: <sup>1)</sup> EN 50636-2-91 <sup>2)</sup> RL 2000/14/EC



The stated vibration emission value has been measured according to a standardized test procedure and can be used for comparison of one electric power tool with another. It can also be used for preliminary evaluation of exposure. The vibration emission value can vary during actual use of the electric power tool.



## 8. ACCESSORIES

<b>FLYMO Filament Cassette and Cutting Filament 500E</b>	<b>FLY021</b>	<b>Part.no.: 513937190</b>
<b>FLYMO Filament Cassette and Cutting Filament 580E/650E</b>	<b>FLY061</b>	<b>Part.no.: 510245990</b>

## 9. Service/Warranty

### **Service:**

Please contact the address on the back page.

### **Warranty:**

In the event of a warranty claim, no charge is levied to you for the services provided.

Husqvarna UK Ltd. offers a two-year warranty (effective as of the date of purchase) for this product. This warranty includes all significant defects of the product that can be proved to be material or manufacturing faults. This warranty is fulfilled by supplying a fully functional replacement product or by repairing the faulty product sent to us free of charge; we reserve the right to choose between these options. This service is subject to the following provisions:

- The product was used for its intended purpose as per the recommendations in the operating instructions.

- Neither the purchaser nor a third party has attempted to repair the product.

This manufacturer's warranty does not affect warranty entitlements against the dealer/retailer.

If problems arise with this product, please contact our Service department or send the defective product along with a brief description of the fault to Husqvarna UK Ltd., making sure to have sufficiently covered any shipping costs and to have followed the relevant postage and packaging guidelines. A warranty claim must be accompanied by a copy of the proof of purchase.

### **Consumables:**

The cutting filament and the filament cassette are consumables and are not included in the guarantee.

# Product liability

In accordance with the German Product Liability Act, we hereby expressly declare that we accept no liability for damage incurred from our products where said products have not been properly repaired by a FLYMO-approved service partner or where original FLYMO parts or parts authorised by FLYMO were not used.

## EC Declaration of Conformity

The undersigned, Husqvarna AB, 561 82 Huskvarna, Sweden, hereby certifies that, when leaving our factory, the products indicated below are in accordance with		the harmonised EU guidelines, EU standards of safety and product specific standards. This certificate becomes void if the products are modified without our approval.	
Description of the product:	Turbotrimmer		
Product type	Contour 500E; 580E; 650E		
Article-Number	CTE25; CTE27; CTE30		
CE-Directives	2006/42/EC 2014/30/EC 2000/14/EC 2011/65/EC		
Harmonized EN	EN 60335-1 EN 50636-2-91 EN ISO 12100		
Deposited Documentation	GARDENA Technical Documentation, M. Kugler, 89079 Ulm		
Conformity Assessment according to	2000/14/EC Procedure: art. 14 Annex VI		
Noise level: measured / guaranteed	CTE25 CTE27 CTE30	92 dB(A) / 96 dB(A) 91 dB(A) / 96 dB(A) 90 dB(A) / 96 dB(A)	
Year of CE marking	2017		
Ulm xx.xx.2017			
Authorized representative:	XXXX		

**Deutschland / Germany**  
GARDENA  
Manufacturing GmbH  
Central Service  
Hans-Lorenser-Straße 40  
D-89079 Ulm  
Produktfragen:  
(+49) 731 490-123  
Reparaturen:  
(+49) 731 490-290  
service@gardena.com

**Albania**  
COBALT Sh.p.k.  
Rr. Sini Kodra  
1000 Tirana

**Argentina**  
Husqvarna Argentina S.A.  
Av. del Libertador 5954 –  
Piso 11 – Torre B  
(C1426ARP) Buenos Aires  
Phone: (+54) 11 5194 5000  
info.gardena@  
ar.husqvarna.com

**Armenia**  
Garden Land Ltd.  
61 Tigran Mets  
0005 Yerevan

**Australia**  
Husqvarna Australia Pty. Ltd.  
Locked Bag 5  
Central Coast BC  
NSW 2252  
Phone: (+61) (0) 2 4352 7400  
customer.service@  
husqvarna.com.au

**Austria / Österreich**  
Husqvarna Austria GmbH  
Industriezeile 36  
4010 Linz  
Tel.: (+43) 732 77 01 01-485  
service.gardena@  
husqvarnagroup.com

**Azerbaijan**  
Firm Progress  
a. Aliyev Str. 26A  
1052 Baku

**Belgium**  
Husqvarna België nv/sa  
Gardena Division  
Rue Egide Van Ophem 111  
1180 Uccle / Ukkel  
Tel.: (+32) 2 720 92 12  
info@gardena.be

**Bosnia / Hercegovina**  
SILK TRADE d.o.o.  
Industrijska zona Bukva bb  
74260 Tešanj

**Brazil**  
Husqvarna do Brasil Ltda  
Av. Francisco Matarazzo,  
1400 – 19º andar  
São Paulo – SP  
CEP: 05001-903  
Tel: 0800-112252  
marketing.br.husqvarna@  
husqvarna.com.br

**Bulgaria**  
AGROLAND България АД  
бул. 8 Декември, №13  
Офис 5  
1700 Студентски град  
София  
Тел.: (+359) 24 66 69 10  
info@agroland.eu

**Canada / USA**  
GARDENA Canada Ltd.  
100 Summerlea Road  
Brampton, Ontario L6T 4X3  
Phone: (+1) 905 792 93 30  
info@gardenacanada.com

**Chile**  
Maquinarias Agroforestales  
Ltda. (Maga Ltda.)  
Santiago, Chile  
Avda. Chesterton  
# 8355 comuna Las Condes  
Phone: (+56) 2 202 4417  
Dalton@maga.cl  
Zipcode: 7560330

**China**  
Husqvarna (Shanghai)  
Management Co., Ltd.  
富世华 (上海) 管理有限公司  
3F, Benq Square B,  
No207, Song Hong Rd.,  
Chang Ning District,  
Shanghai, PRC. 200335  
上海市长宁区虹虹路207号明  
基广场B座3楼, 邮编: 200335

**Colombia**  
Husqvarna Colombia S.A.  
Calle 18 No. 68 D-31, zona  
Industrial de Montevideo  
Bogotá, Cundinamarca  
Tel. 571 2922700 ext. 105  
jairo.salazar@  
husqvarna.com.co

**Costa Rica**  
Compania Exim  
Euroberoamericana S.A.  
Los Colegios, Moravia,  
200 metros al Sur del Colegio  
Saint Francis – San José  
Phone: (+506) 297 68 83  
exim\_euro@racsa.co.cr

**Croatia**  
Husqvarna Austria GmbH  
Industriezeile 36  
4010 Linz  
Tel.: (+43) 732 77 01 01-485  
service.gardena@  
husqvarnagroup.com

**Cyprus**  
Med Marketing  
17 Digeni Akritia Ave  
P.O. Box 27017  
1641 Nicosia

**Czech Republic**  
Husqvarna Cesko s.r.o.  
Türkova 2319/5b  
149 00 Praha 4 – Chodov  
Bezplatná infolinka:  
800 100 425  
servis@cz.husqvarna.com

**Denmark**  
GARDENA DANMARK  
Lejrevej 19, st.  
3500 Værløse  
Tlf.: (+45) 70264770  
husqvarna@husqvarna.dk  
www.gardena.com/dk

**Dominican Republic**  
DOMSQUESA, S.R.L.  
Carretera Santiago Licey  
Km. 5 ½  
Esquina Copal II,  
Santiago  
Dominican Republic  
Phone: (+809) 736-0333  
joserbosquesa@claro.net.do

**Ecuador**  
Husqvarna Ecuador S.A.  
Arupos E1-181 y 10 de  
Agosto Quito, Pichincha  
Tel. (+593) 22800739  
francisco.jacome@  
husqvarna.com.ec

**Estonia**  
Husqvarna Eesti OÜ  
Valdeku 132  
EE-11216 Tallinn  
info@gardena.ee

**Finland**  
Oy Husqvarna Ab  
Gardena Division  
Lautatarhankatu 8 B/PL 3  
00581 HELSINKI  
www.gardena.fi

**France**  
Husqvarna France  
9/11 Allée des pierres mayettes  
92635 Gennevilliers Cedex  
France  
http://www.gardena.com/fr  
N° AZUR: 0 810 00 78 23  
(Prix d'un appel local)

**Georgia**  
Transporter LLC  
8/57 Bellashvili street  
0159 Tbilisi, Georgia  
Phone: (+995) 322 14 71 71

**Great Britain**  
Husqvarna UK Ltd  
Preston Road  
Aycliffe Industrial Park  
Newton Aycliffe  
County Durham  
DL5 6UP  
info.gardena@  
husqvarna.co.uk

**Greece**  
Π.ΠΑΠΑΔΟΠΟΥΛΟΣ ΑΕΒΕ  
Λεωφ. Αθηνών 92  
Αθήνα  
Τ.Κ. 104 42  
Ελλάδα  
Τηλ. (+30) 210 51 93 100  
info@papadopoulos.com.gr

**Hungary**  
Husqvarna Magyarorszáig Kft.  
Ezred u. 1-3  
1044 Budapest  
Telefon: (+36) 1 251-4161  
vevozzolgalat.husqvarna@  
husqvarna.hu

**Iceland**  
O. Johnson & Kaaber  
Tunguhalsi 1  
110 Reykjavik  
ooj@ojk.is

**Ireland**  
Husqvarna UK Ltd  
Preston Road  
Aycliffe Industrial Park  
Newton Aycliffe  
County Durham  
DL5 6UP  
info.gardena@  
husqvarna.co.uk

**Italy**  
Husqvarna Italia S.p.A.  
Via Santa Vecchia 15  
23868 VALMADRERA (LC)  
Phone: (+39) 0341.203.111  
assistenza.italia@  
it.husqvarna.com

**Japan**  
KAKUICHI Co. Ltd.  
Sumitomo Realty &  
Development Kojimachi  
BLDG. 8F  
5-1 Nibanncyo  
Chiyoda-ku  
Tokyo 102-0084  
Phone: (+81) 33 264 4721  
m\_ishihara@kaku-ichi.co.jp

**Kazakhstan**  
LAMED Ltd.  
155/1, Tazhibayevoi Str.  
050060 Almaty  
IP Schmidt  
Abayavenue 3B  
110 005 Kostanay

**Korea**  
Kyung Jin Trading CO.,LTD.  
107-4, SunDuk Bld.,  
Yangjae-dong,  
Seocho-gu,  
Seoul, (zipcode: 137-891)  
Etel: (+82) (0)2 574-6300

**Kyrgyzstan**  
Alye Maki  
av. Mcladaya Guardir J 3  
720014  
Bishkek

**Latvia**  
Husqvarna Latvija SIA  
Ulbrokas 19A  
LV-1021 Riga  
info@gardena.lv

**Lithuania**  
UAB Husqvarna Lietuva  
Aiteities pl. 77C  
LT-52104 Kaunas  
info@gardena.lt

**Luxembourg**  
Magasins Jules Neuberg  
39, rue Jacques Stas  
Luxembourg-Gasperich 2549  
Case Postale No. 12  
Luxembourg 2010  
Phone: (+352) 40 14 01  
api@neuberg.lu

**Mexico**  
AFOSA  
Av. Lopez Mateos Sur # 5019  
Col. La Calma 45070  
Zapopan, Jalisco  
Mexico  
Phone: (+52) 33 3818-3434  
icornejo@afosa.com.mx

**Moldova**  
Comel S.R.L.  
230A Muncesti Str.  
2002 Chisinau

**Netherlands**  
Husqvarna Nederland B.V.  
GARDENA Division  
Postbus 50131  
1305 AC ALMERE  
Phone: (+31) 36 521 00 10  
info@gardena.nl

**Neth. Antilles**  
Jonka Enterprises N.V.  
Sta. Rosa Weg 196  
P.O. Box 8200  
Curaçao  
Phone: (+599) 9 767 66 55  
pgm@jonka.com

**New Zealand**  
Husqvarna New Zealand Ltd.  
PO Box 76-437  
Manukau City 2241  
Phone: (+64) (0) 9 9202410  
support.nz@husqvarna.co.nz

**Norway**  
Husqvarna Norge AS  
Gardena Division  
Trøskerveien 36  
1708 Sarpsborg  
info@gardena.no

**Peru**  
Husqvarna Perú S.A.  
Jr. Ramón Cárcamo 710  
Lima 1  
Tel: (+51) 1 3320400 ext. 416  
juan.remuzgo@  
husqvarna.com

**Poland**  
Husqvarna  
Poland Spółka z o.o.  
ul. Wysockiego 15 b  
03-371 Warszawa  
Phone: (+48) 22 330 96 00  
gardena@husqvarna.com.pl

**Portugal**  
Husqvarna Portugal, SA  
Lagoa - Albarraque  
2635 - 595 Rio de Mourto  
Tel: (+351) 21 922 85 30  
Fax: (+351) 21 922 85 36  
info@gardena.pt

**Romania**  
Madex International Srl  
Soseaua Odail 117-123,  
RO 013603 Bucuresti, S1  
Phone: (+40) 21 352.76.03  
madex@mes.ro

**Russia / Россия**  
ООО „Хускварна“  
141400, Московская обл.,  
г. Химки,  
улица Ленинградская,  
владение 39, стр.6  
Бизнес Центр  
„Химки Бизнес Парк“,  
помещение ОВ02\_04  
http://www.gardena.ru

**Serbia**  
Dodel d.o.o.  
Autoput za Novi Sad bb  
11273 Belgrade  
Phone: (+381) 11 848 88 12  
miroslav.jejina@dodel.rs

**Singapore**  
Hy-Ray PRIVATE LIMITED  
40 Jalan Pemimpin  
#02-08 Tat Ann Building  
Singapore 577185  
Phone: (+65) 6253 2277  
shiyang@hyray.com.sg

**Slovak Republic**  
Husqvarna Cesko s.r.o.  
Türkova 2319/5b  
149 00 Praha 4 – Chodov  
Bezplatná infolinka:  
800 154 044  
servis@sk.husqvarna.com

**Slovenia**  
Husqvarna Austria GmbH  
Industriezeile 36  
4010 Linz  
Tel.: (+43) 732 77 01 01-485  
service.gardena@  
husqvarnagroup.com

**South Africa**  
Husqvarna  
South Africa (Pty) Ltd  
Postnet Suite 250  
Private Bag X6,  
Cascades, 3202  
South Africa  
Phone: (+27) 33 846 9700  
info@gardena.co.za

**Spain**  
Husqvarna España S.A.  
Calle de Rivas nº 10  
28052 Madrid  
Phone: (+34) 91 708 05 00  
atencioncliente@gardena.es

**Suriname**  
Agrofix n.v.  
Verlengde Hoogstraat # 22  
Phone: (+597) 472426  
agrofix@sr.net  
Pobox : 2006  
Paramaribo  
Suriname – South America

**Sweden**  
Husqvarna AB  
Gardena Division  
S-561 82 Huskvarna  
gardenaorder@husqvarna.se

**Switzerland / Schweiz**  
Husqvarna Schweiz AG  
Consumer Products  
Industriestrasse 10  
5506 Mägenstrin  
Phone: (+41) (0) 62 887 37 90  
info@gardena.ch

**Turkey**  
Dost Bahçe Diş Ticaret  
Müessesilik A.Ş  
Yunus Mah. Adil Sok. No:3  
İc Kapı No: 1 Kartal  
34873 İstanbul  
Phone: (+90) 216 38 93 939  
info@dostbahce.com.tr

**Ukraine / Україна**  
ТОВ „Хускварна Україна“  
вул. Васильківська, 34,  
офіс 204-р  
03022, м. Київ  
Тел. (+380) 044 498 39 02  
info@gardena.ua

**Uruguay**  
FELI SA  
Entre Rios 1083 CP 11800  
Montevideo - Uruguay  
Tel: (+598) 22 03 18 44  
info@felisa.com.uy

**Venezuela**  
Corporación Casa y Jardin C.A.  
Av. Caroní, Edif. Trezmen, PB.  
Colinas de Bello Monte,  
1000 Caracas.  
Tlf: (+58) 212 992 33 22  
info@casayjardin.net.ve

C500E-20.960.01/0217  
Husqvarna AB  
S-561 82 Huskvarna  
Sweden

Our policy of continuous improvement means that the specification of products may be altered from time to time without prior notice.

Copyright © 2015 Flymo S.A. All rights reserved.

Flymo® and other product and feature names are registered or unregistered trademarks of Flymo S.A.

